

Sensory map

Sensory map

Ground floor

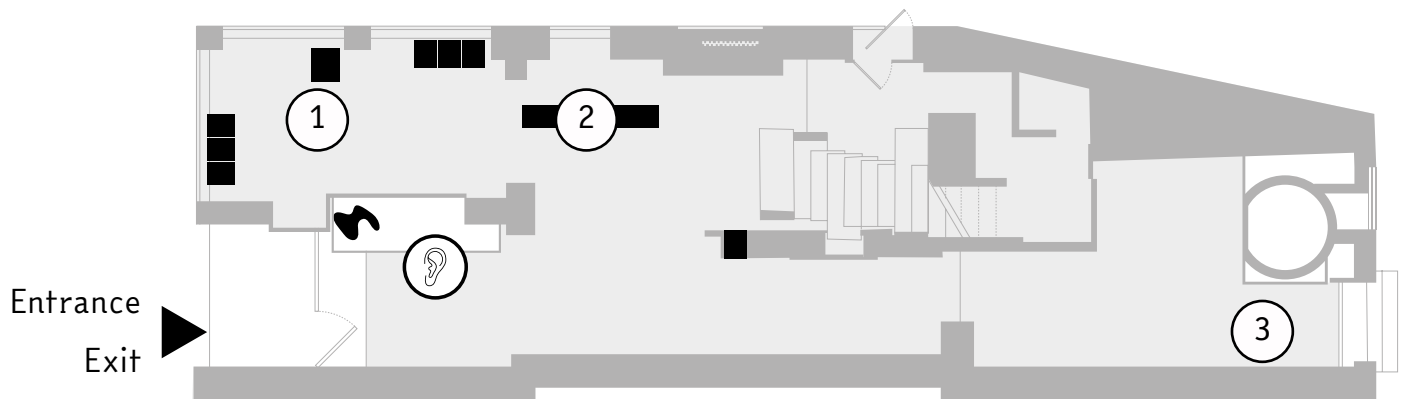

Here you can see:

- 1 - typewriters and calculating machines
- 2 - the ticket counter
- 3 - the Water Door [Porta d'acqua]

Legend:

-  Here you might hear people talking

First floor

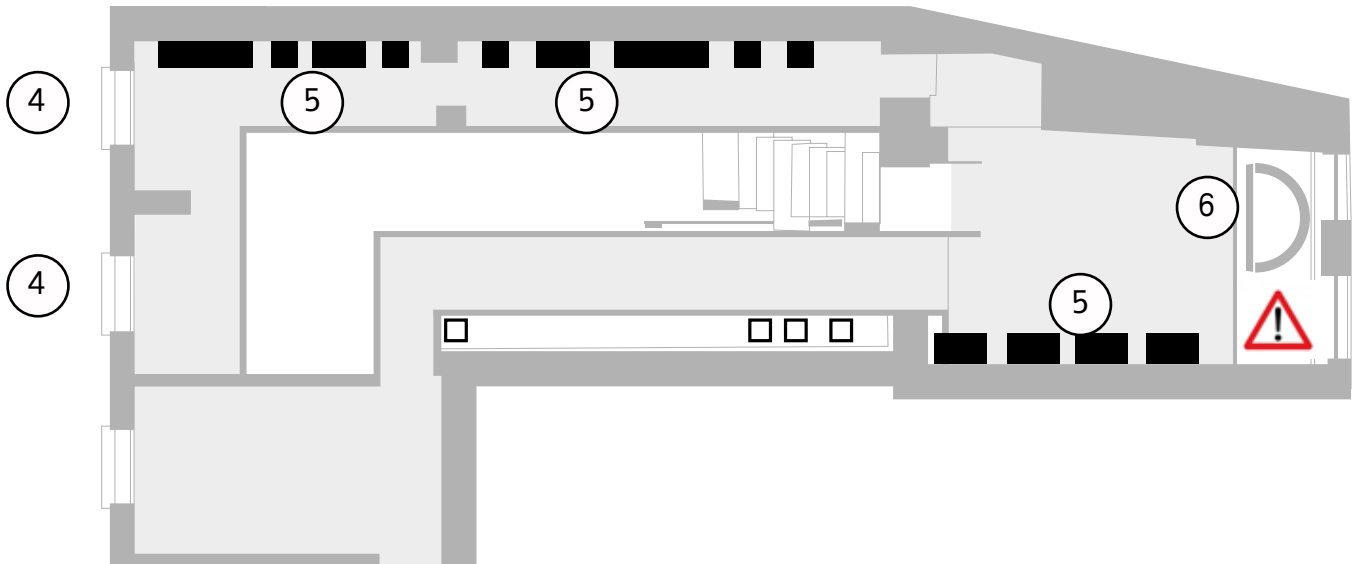

Here you can see:

4 - the eye windows

5 - typewriters and calculating machines

6 - plants

Legend:

 Here there is no protection.